

EDISON S. STURGES  
DB 242 PG 802  
MB 18 PG 84

TAR RIVER LAND CONSERVANCY INC  
DB 2356 PG 786  
MB 32 PG 289

JOHN HANCOCK LIFE INSURANCE COMPANY  
DB 2638 PG 317  
PB 2A PG III



1

3

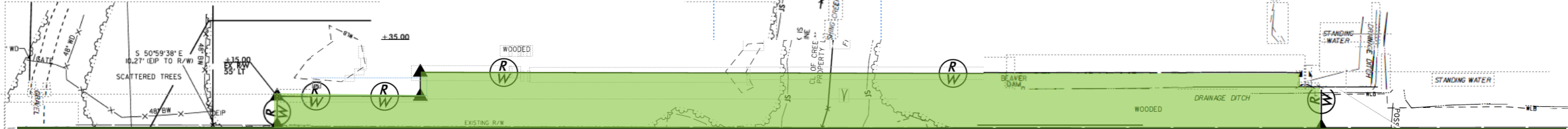

Bridge To Be Replaced

Temporary Bridge

2

TAR RIVER LAND CONSERVANCY INC  
DB 2763 PG 639  
MB 39 PG 86

4

